

Quick connector, 6 mm slot, 0°, 90° cap

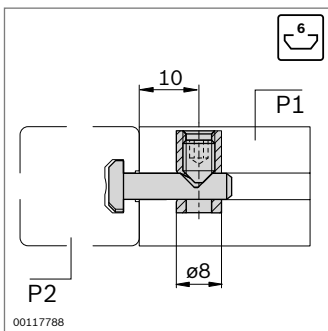

- ▶ For right-angled connections between two profiles
- ▶ Excellent accessibility for tools during mounting
- ▶ Quick connector for 6 mm slot with square head; can be used as a 0° or 90° connector
- ▶ Profile machining:
blind hole DB8 or through-hole D8

Accessories, optional:
drilling jig (p. 14-2)

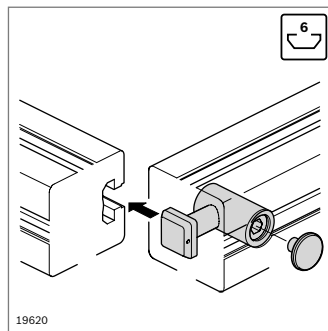
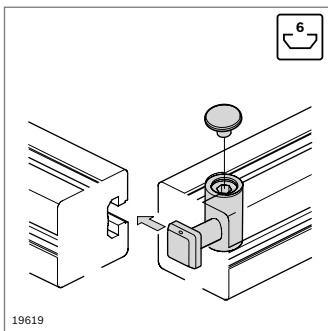

Slot	F_{max}	M_{max}
6 / 6	450 N	18 Nm

Quick-clamp connector, P1 / P2	D (mm)	ESD	No.
0° / 90°	6 / 6	8	10
			3 842 537 013

Material: Steel, stainless

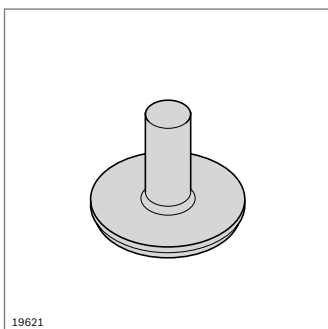

- ▶ Cap for connector sleeves

Cap	D (mm)	No.
	8	100
		3 842 538 562

Material: PE, light gray RAL 7035

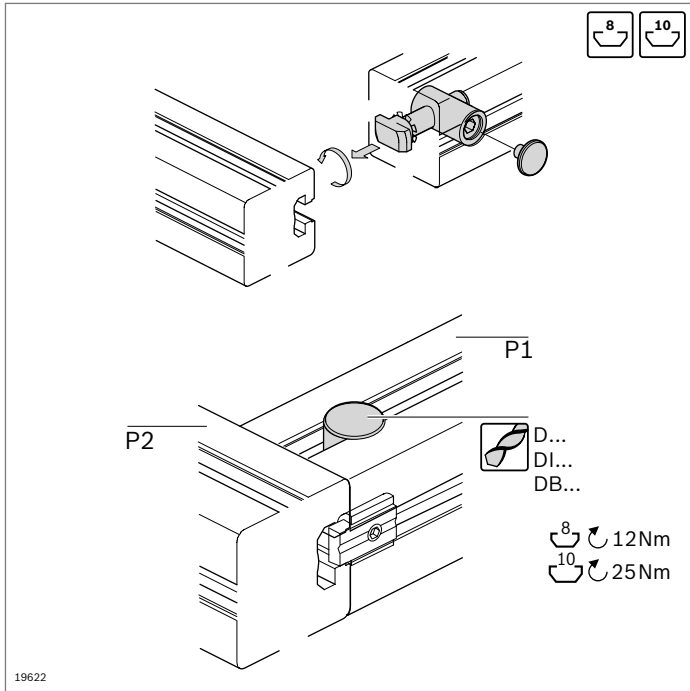

Quick connector, 8/10 mm slot, 0°



- ▶ For right-angled connections between two profiles
- ▶ Excellent accessibility for tools during mounting
- ▶ O-ring for mounting enables overhead assembly
- ▶ Quick connectors can be swiveled into the profile slot at the point of assembly
- ▶ Profile machining:
blind hole DI, DB11, DB17 or through hole DI, D11, D17
- ▶ Note differing drilling intervals and load-bearing capacities when using with radial compensation ("Technical data" p. 19-6)

Accessories, optional:

- ▶ Anti-torsion element (p. 3-39)
- ▶ Radial compensation (p. 2-83)
- ▶ Drilling jig (p. 14-2)
- ▶ Cap (p. 3-51)

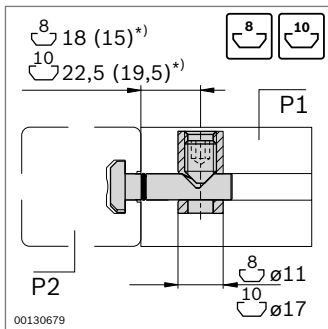

Slot	F_{max}	M_{max}
8 / 8	500 N	40 Nm
8 / 10	2000 N	70 Nm
10 / 10	4000 N	140 Nm

*) With the use of a radial compensation

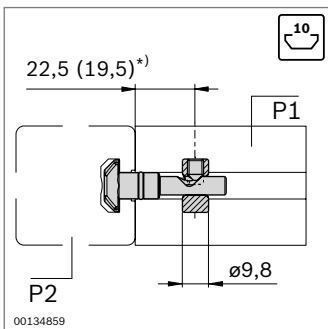

Slot	F_{max}	M_{max}
10 / 10	800 N	50 Nm

*) With the use of radial compensation

Quick connector, 0°	P1 / P2	D ESD	No.
	(mm)		
Steel, galvanized	8 / 8	11	3 842 535 459
	8 / 10	11	3 842 535 464
	10 / 10	17	3 842 535 458
Steel, stainless	8 / 8	11	3 842 548 934
	8 / 10	11	3 842 548 935
	10 / 10	17	3 842 548 936

- ▶ Quick connector 9.8 with smaller connector sleeve
- ▶ The hole for the connector sleeve does not make contact with the slot flanks. This permits a visually attractive connection; the slot can be completely closed with the cover profile

Quick connector 0°, connector sleeve D = 9.8	P1 / P2	D ESD	No.
	(mm)		
Steel, galvanized	10 / 10	9.8 ¹⁾	3 842 541 412

¹⁾ No standard hole in modular dimensions 40, 50 and 60, target distance from profile end: 22.5 mm

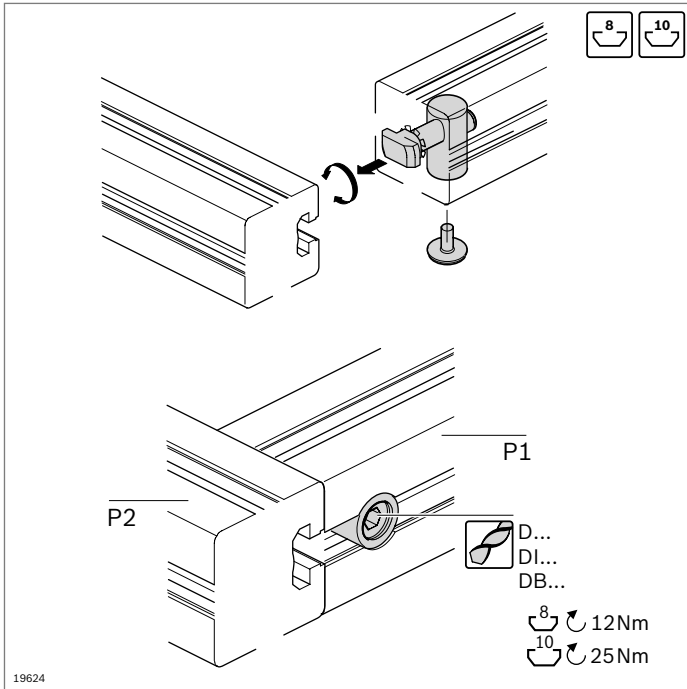

Quick connector, 8/10 mm slot, 90°, Cap



- ▶ Tie rod head rotated at a 90° angle to the connector sleeve
- ▶ Profile machining:
blind hole DI, DB11, DB17 or through hole DI, D11, D17

Accessories, optional:

- ▶ Anti-torsion element (p. 3-39)
- ▶ Radial compensation (p. 2-83)
- ▶ Drilling jig (p. 14-2)
- ▶ Cap

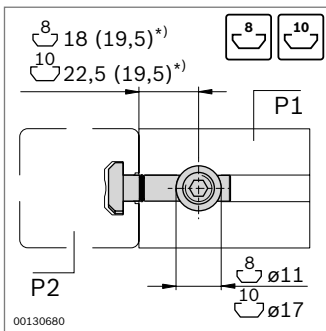

Slot	F_{max}	M_{max}
8 / 8	2000 N	70 Nm
10 / 10	4000 N	140 Nm

*) With the use of a radial compensation

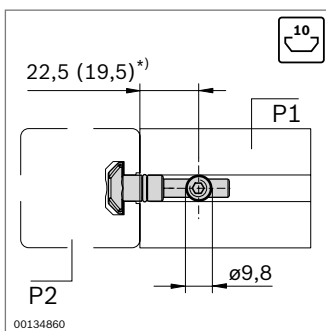

Slot	F_{max}	M_{max}
10 / 10	800 N	50 Nm

*) With the use of a radial compensation

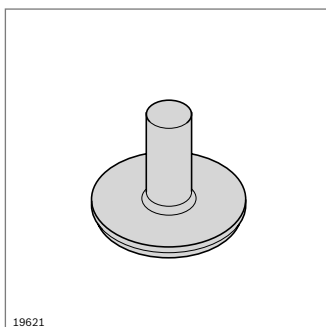

Quick connector, 90°	P1 / P2	D ESD	No.
		(mm)	
Steel, galvanized	8 / 8	11	10 3 842 535 465
	10 / 10	17	10 3 842 535 466
Steel, stainless	8 / 8	11	10 3 842 548 937
	10 / 10	17	10 3 842 548 938

Quick connector 90°, connector sleeve D = 9.8	P1 / P2	D ESD	No.
		(mm)	
Steel, galvanized	10 / 10	9.8 ¹⁾	10 3 842 541 410

¹⁾ No standard hole in modular dimensions 40, 50 and 60
Target distance from profile end: 22.5 mm

Cap	D (mm)	No.
	11	100 3 842 538 563
	17	100 3 842 538 564

Material: PE, light gray RAL 7035

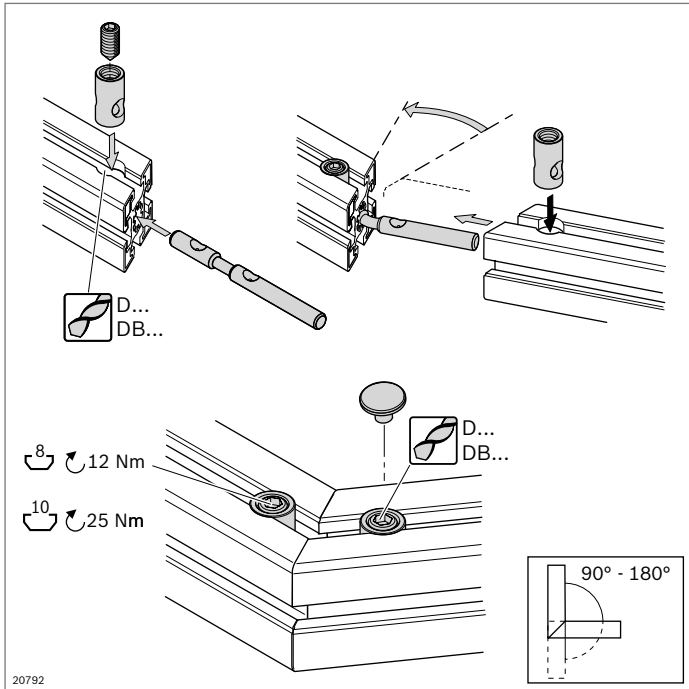

Quick connector, bendable – end-to-end

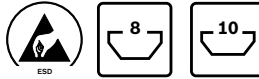

- ▶ For end-to-end connecting of two profiles with equal cross-sections and at any angle, e.g. for frames
- ▶ Profile machining:
 - blind hole DB11, DB17 or through hole D11, D17
 - miter cut

Technical data (p. 19-6)

Accessories:

- ▶ drilling jig (p. 14-2)
- ▶ cap (p. 3-51)

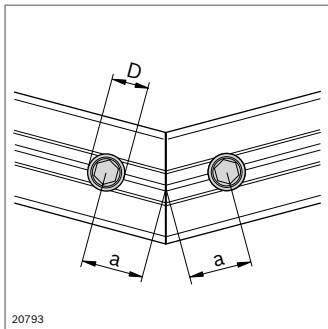

	M_{max}
30x30	24 Nm
40x40L	100 Nm
45x45L	110 Nm
45x45	145 Nm
50x50L	160 Nm

Quick connector, bendable	P1 / P2	a (mm)	D (mm)	ESD	No.
End-to-end	8 / 8	18	11	10	3 842 535 630
	10 / 10	22.5	17	10	3 842 535 634

Material: Tie rod: steel, stainless
Socket: steel, galvanized

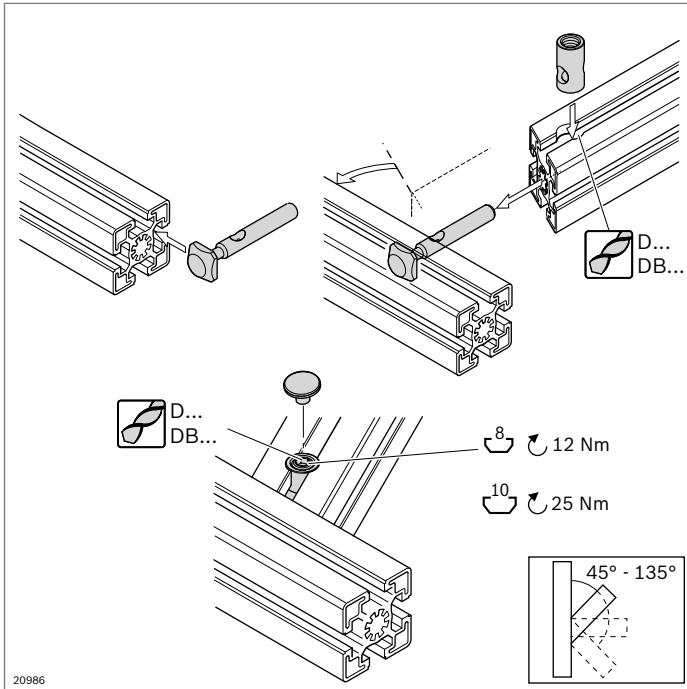

20986

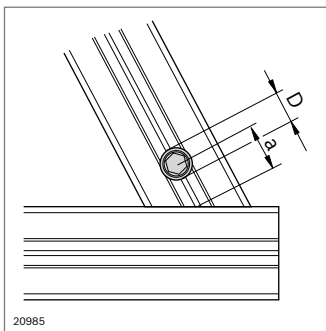

20985

Quick connector, bendable – end-to-slot



- ▶ For end-to-slot connecting of two profiles at any angle, e.g. for framework constructions
- ▶ Profile machining:
 - blind hole DB11, DB17 or through-hole D11, D17
 - miter cut

Technical data (p. 19-6)

Accessories:

- ▶ drilling jig (p. 14-2)
- ▶ cap (p. 3-51)

Quick connector, bendable	P1 / P2	a (mm)	D (mm)	ESD	No.
End-to-slot	8 / 8	18	11		10 3 842 535 629
	10 / 10	22.5	17		10 3 842 535 635

Material: Tie rod: steel, stainless
Socket: steel, galvanized

30x30	1100 N	35 Nm	650 N	40 Nm
40x40L	1500 N	110 Nm	1000 N	80 Nm
45x45L	1500 N	120 Nm	1000 N	95 Nm
45x45	1500 N	140 Nm	1100 N	180 Nm
50x50L	1500 N	150 Nm	1100 N	180 Nm